

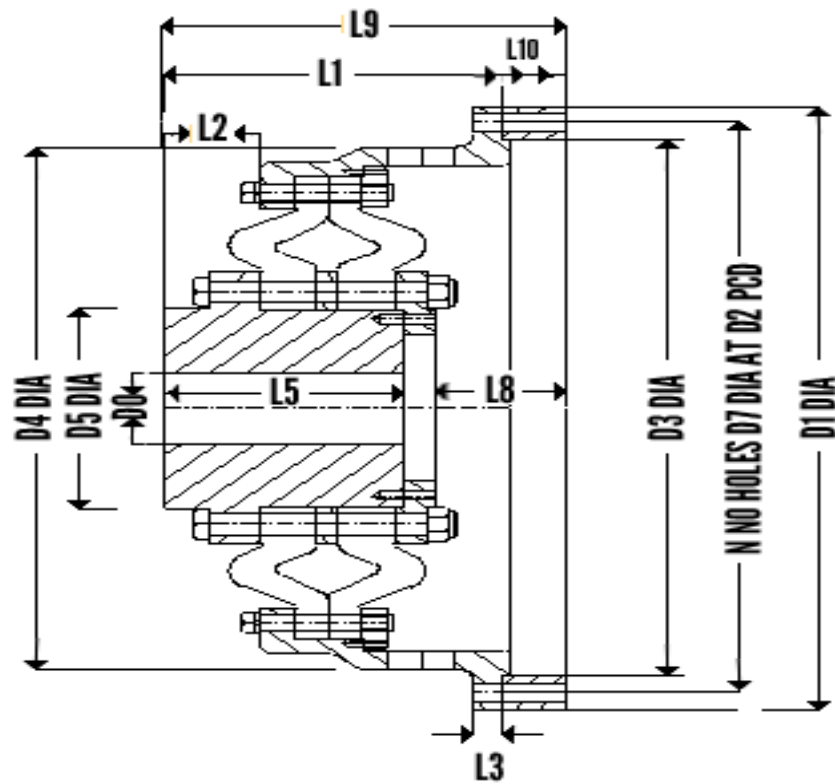

Unique Double Diaphragm Coupling

**Series 1100**

**GENERAL ASSEMBLY DRAWING**



**DIMENSIONS AND STANDARD SIZES**

SIZE VEZ	Max Speed		Dimensions								D0 MAX				Inertia MR <sup>2</sup>				
	CI RPM	CS RPM	L1 mm	L2 mm	L3 mm	L5 mm	L8 mm	L9 mm	L7 mm	D1 mm	D2 mm	D3 mm	CI mm	Steel mm	N mm	D7 mm	Weight KG	Inner Kg.m <sup>2</sup>	Outer Kg.m <sup>2</sup>
35S,40S	4600	6700	71	16	8	52	37	98	3	221	205	189	35	35	12	10.0	8	0.002	0.047
43S,45S	4000	5870	83	21	8	62	38	110	3	252	235	218	45	50	12	10.0	10.9	0.006	0.078
51S,55S	3400	5500	92	23	10	69	38	119	3	290	268	246	50	55	12	11.0	14.9	0.011	0.150
60S	3400	5100	92	23	10	69	38	119	3	290	268	246	60	65	12	11.0	15.9	0.022	0.150
61S,65S	2850	4480	106	26	12	80	50	143	3	330	304	276	60	65	12	15.0	24.2	0.022	0.291
70S	2850	4480	106	26	12	80	50	143	3	335	308	283	70	75	12	15.0	25.5	0.039	0.299
71S,80S	2500	3890	132	36	14	103	43	162	3	380	354	328	70	75	12	15.0	35.5	0.052	0.527
82S	2500	3890	107	35	15	98	43	157	3	370	350	320	70	75	12	11.0	35.5	0.055	0.527
85S	2160	3330	108	42	15	110	48	177	3	400	370	340	90	100	12	10.5	57.7	0.098	1.036
86S,95S	2160	3330	162	47	14	126	48	193	4	445	420	392	90	100	12	15.0	57.7	0.172	1.036
102S,115S	1880	2880	185	52	16	143	58	223	4	514	486	458	105	120	16	17.0	104	0.324	2.188
121S,135S	1620	2500	216	66	18	168	67	261	5	593	561	529	120	135	16	17.0	138	0.736	4.179
141S,165S	1370	2150	254	75	23	199	75	304	5	690	650	610	140	160	16	22.0	211	1.390	9.143
171S,195S	1160	1840	283	82	25	222	93	349	6	808	767	726	170	190	16	26.0	366	3.340	22.880
201S,235S	980	1540	331	100	28	258	110	408	8	956	908	858	200	230	16	32.0	594	7.550	52.300
241S,275S		1340	388	116	32	302	138	488	8	1110	1051	992		280	16	35.0	950	17.000	112.600
280S,285S		1170	476	116	34	358	197	605	8	1262	1195	1128		310	16	35.0	1640	36.500	255.000
310S,320S		1080	520	131	40	400	225	680	10	1386	1315	1244		330	24	38.0	2074	52.900	418.000
360S		1080	520	131	40	400	225	680	10	1386	1315	1244		330	24	38.0	2074	52.900	418.000

