

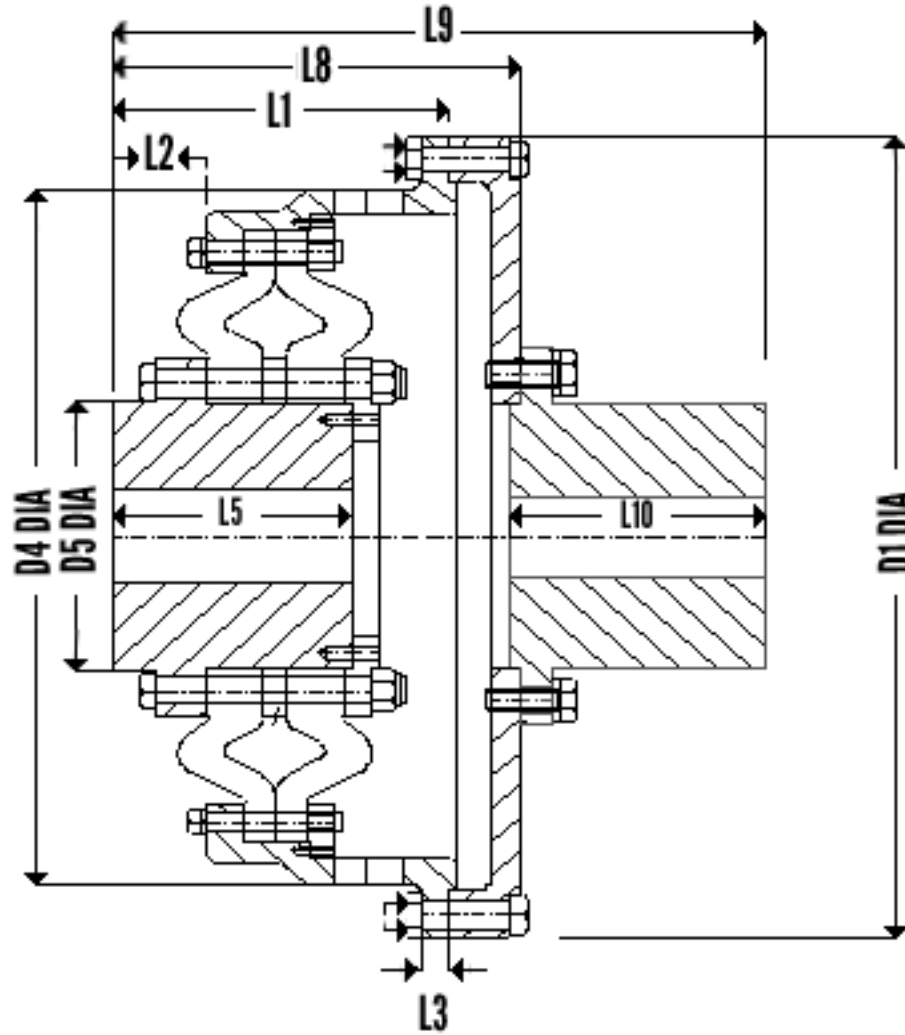

Unique Double Diaphragm Coupling
Series 1750

GENERAL ASSEMBLY DRAWING



DIMENSIONS AND STANDARD SIZES

SIZE VEZ	Max Speed		Dimensions										D0 MAX		D6		Inertia MR ²			
	CI RPM	CS RPM	L1 mm	L2 mm	L3 mm	L5 mm	L8 mm	L9 mm	L10 mm	D1 mm	D2 mm	D3 mm	CI mm	Steel mm	MAX mm	N mm	D7 mm	Weight KG	Inner Kg.m ²	Outer Kg.m ²
35S,40S	4600	6700	71	16	8	52	104	157	56	221	205	189	35	35	52	12	10	11.6	0.002	0.057
43S,45S	4000	5870	83	21	8	62	117	176	62	252	235	218	45	50	58	12	10	16	0.006	0.098
51S,55S	3400	5500	92	23	10	69	128	196	71	290	268	246	50	55	70	12	11	22.8	0.011	0.196
60S	3400	5100	92	23	10	69	128	196	71	290	268	246	60	65	70	12	11	23.8	0.022	0.196
61S,65S	2850	4480	106	26	12	80	157	243	90	330	304	276	60	65	80	12	15	36.6	0.022	0.382
70S	2850	4480	106	26	12	80	157	243	90	335	308	283	70	75	80	12	15	37.9	0.039	0.382
71S,80S	2500	3890	132	36	14	103	178	285	111	380	354	328	70	75	110	12	15	59.3	0.052	0.755
82S	2500	3890	107	35	15	98	173	280	111	370	350	320	70	75	110	12	11	59.3	0.055	0.755
85S	2160	3330	108	42	15	110	192	316	129	400	370	340	90	100	130	12	10.5	94.8	0.098	1.535
86S,95S	2160	3330	162	47	14	126	208	332	129	445	420	392	90	100	130	12	15	94.8	0.172	1.535
102S,115S	1880	2880	185	52	16	143	242	387	150	514	486	458	105	120	150	16	17	147	0.324	3.267
121S,135S	1620	2500	216	66	18	168	285	455	175	593	561	529	120	135	170	16	17	230	0.736	6.52
141S,165S	1370	2150	254	75	23	199	331	521	196	690	650	610	140	160	205	16	22	358	1.39	14
171S,195S	1160	1840	283	82	25	222	349	572	229	808	767	726	170	190	245	16	26	567	3.34	29.8
201S,235S	980	1540	331	100	28	258	408	675	272	956	908	858	200	230	290	16	32	950	7.55	69.2
241S,275S		1340	388	116	32	302	488	823	340	1110	1051	992		280	330	16	35	1561	17.0	152.8
280S,285S		1170	476	116	34	358	605	957	358	1262	1195	1128		310	355	16	35	2437	36.5	329.6
310S,320S		1080	520	131	40	400	680	1147	475	1386	1315	1244		330	380	24	38	3347	52.9	540
360S		1080	520	131	40	400	680	1147	475	1386	1315	1244		330	380	24	38	3347	52.9	540

